

Tyre diameter
1.650 - 3.700 mm
65 - 146"

Lift capacity
8.000 kg
17.600 lbs

Ideal for:
Tyre Service
Open Pit Mines & Quarries
Tyre Manufacturers / Dealers
OEM / Workshops / Assembly Lines

Easy
Gripper
3700-8T

Save
time
Improve
safety

DISCLAIMER: Forklift shown is for demonstration purposes only!

Professional tools for handling of OTR/EM tyres up to 46/90R57

- Unique 3-point grip
- Precise rotation +/-25°
- 60° tilt, horizontal to vertical
- Tools for safe handling of tyre rings
- Integrated camera system for optimal view
- Prevent damage to tyres, rims & equipment
- Customization available



Experts in Tyre Handling Equipment



Easy Gripper

The Easy Gripper product range is designed to help tyre professionals in a multitude of conditions and situations. Implementing The Easy Gripper makes tyre handling faster and safer, while preventing damage to tyres, rims and equipment.

Capability

With a gripping range from $\text{Ø}1.650 - 3.700 \text{ mm}$ (65 - 146") and a lifting capacity of 8 ton (17.600 lbs) at a CoG of 650mm (26"), the Easy Gripper 3700-8T handles tyres up to 46/90R57. When handling full wheel assemblies as inside duals, the Gripper handles up to 40.00R57 tyres.



Open pit mines & quarries

Reduces down time and improves the safety for the tyre technicians. See also the tools for handling the rings, when mounting or demounting tyres.

Tyre manufacturers / dealers

For use in tyre production, warehouse, loading and unloading. Fast and safe handling – horizontal and vertical.



Tyre service

As stationary solution in open pit mines or as mobile solution mounted on forklift, front loader or telehandler.

OEM

Handling of tyres and wheels from unloading to warehouse and assembly lines. Mounting of wheels with tilt, precise rotation and camera system.



Forklifts



The Easy Gripper 3700-8T with the 90° tilt module, is ideal for use on forklifts.

Front loaders and telehandlers



The Easy Gripper 3700-8T Compact without tilt or with the 60° tilt module is a good choice depending on the tilt the carrier can provide.

Standard features

Unique and safe 3-point grip

Prevents accidents.
Prevents deformation of tyres.
Prevents damages to tyres, rims and equipment.

Integrated camera system with 2 cameras

For optimal view and for precise hub and bolt alignment.
With automatic IR function in insufficient light conditions.

Precise rotation +/-25°

35° or 90° tilt, horizontal to vertical

LED working light



Unique and safe 3-point grip



Integrated camera system for optimal view

Optional accessories

Customized attachment system

Can be customized with quick coupler option depending on carrier.

Easy shift of gripping pipes for various purposes

Telescopic pipes for long reach, to provide room for the tyre technicians and for dual tyre handling.
Flat top arm for limited tyre clearance

Ring Handling Tools

Enables the tyre fitter to handle Locking Rings, O-Rings, Side Rings and Bead Seat Bands in a safe and secure manner.

RIM Handling Tools

The RIM Handling tools are yet a safety and efficiency add-on to the Easy Gripper program and improve the handling of OTR rims.

Customization on request

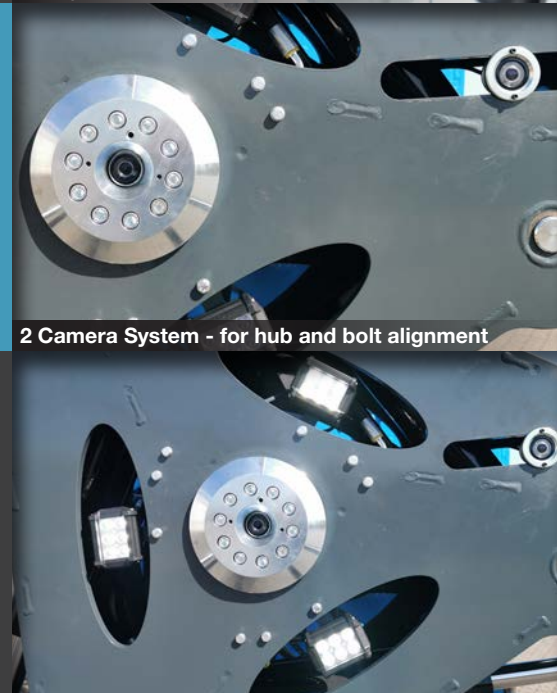

2 Camera System - for hub and bolt alignment



Interface for carrier specific attachment



Flat top arm for limited tyre clearance



Telescopic pipes for long reach



Tools for safe handling of tyre rings



Safe handling of rims

Technical Specifications:

| | |
|-------------------|--|
| Weight: | 60° = 5.280 kg (11.640 lbs) |
| Lifting capacity: | 8.000 kg (17.600 lbs) at C from B 650 mm (25.6") |
| | 5.200 kg (11.464 lbs) at D from B 1.750 mm (68.9") |
| Tyre diameter: | 1.650 - 3.700 mm (65 - 145.7") |
| Standard pipes: | Ø256 x 1.460 mm (10.1 x 57.5") |
| Telescopic pipes: | Ø295 x 1.480 -> 2.260 mm (11.6 x 58.3 -> 89") |

60° tilt module

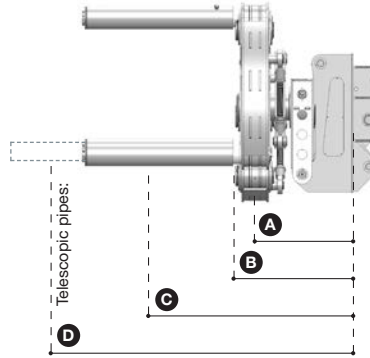

- A** CoG Gripper = 970 mm (38.2")
- B** Face of Gripper = 1.145 mm (45.1")
- C** CoG Load1 = 1.795 mm (70.7")
- D** CoG Load2 = 2.895 mm (114.0")

Technical Requirements:

| | |
|--------------------|--|
| Lifting capacity: | Minimum 20 - 22 ton depending on carrier |
| Attachment: | Terminal West / Loader specific |
| Electrical supply: | 24V / min 10A |
| Hydraulic supply: | 1 double acting circuit (A+B port) |
| Pressure min-max: | 145 - 250 bar (2.103 - 3.626 psi) |
| Return pressure: | max. 10 bar (145 psi) |
| Flow: | max. 75 l/min. (19,8 gal/min.) |

Authorized Dealer



+45 72 344 344
 info@justeasytools.dk
 www.justeasytools.com
 VAT no.: DK33644809

Just Easy Tools ApS
 Nybovej 33
 7500 Holstebro
 Denmark